

DONOR RECOGNITION PLAN: LIVESTOCK CENTER

The Livestock Center will include:

- Up to 5,000-seat stadium arena designed to host a wide variety of events
- 230,000-square-foot livestock hall, also designed for flexible use
- Livestock auction arena with 700 seats
- Outdoor plaza

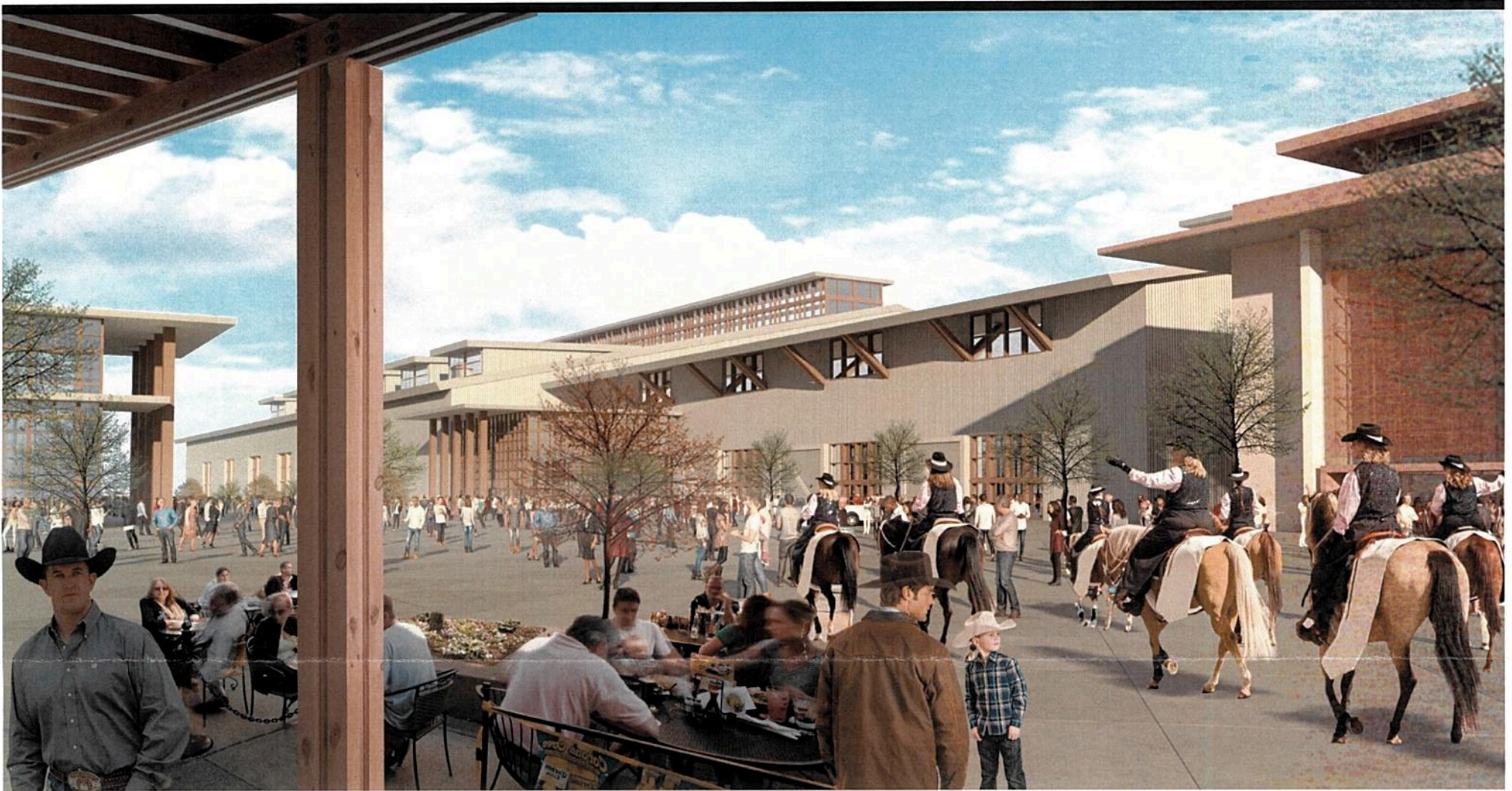

Space	Total Contribution	Payment per year over 3 years	Payment per year over 5 years	Status
1 LIVESTOCK CENTER BUILDING	\$25,000,000	\$8,333,333	\$5,000,000	Available
2 LIVESTOCK CENTER ARENA AND SHOW RING	\$10,000,000	\$3,333,333	\$2,000,000	Available
3 LIVESTOCK CENTER AUCTION ARENA	\$10,000,000	\$3,333,333	\$2,000,000	Available
4 LIVESTOCK CENTER HALL	\$7,000,000	\$2,333,333	\$1,400,000	Available
5 SEATS (per section)	\$250,000	\$83,333	\$50,000	Available
6 WASH RACKS (2)	\$50,000	\$16,667	\$10,000	1 SOLD 1 Available
7 WALL OF BRANDS	\$5,000–50,000	\$1,667–16,666	\$1,000–10,000	Available

